

Electronic Sounders



Dedicated Electronic Sounders for general-purpose audible alarm applications.

New to the range is a new 110dB (A) IP65 32-tone electronic sounder designed to complement both the Series T and Series E warning beacons. The 32 tones are selected using an internal DIP-switch array. Simple 2-wire connection to energise sounder with second-stage tone available on a third wire. Maximum volume can be adjusted via an internal preset control. Full range of supply voltages accommodated - 12Vdc, 24Vdc, 115Vac and 230Vac

Choice of Red, Black or White polycarbonate horn moulding to either match or be distinguishable from existing equipment. IAS-T features black polycarbonate base, IAS-E features white ABS base.

IAS-T and IAS-E models are also available with additional connections for remote selection of tone.

Heavy-duty IAS-1 with single swept frequency tone. Can be supplied without driver circuit for general purpose 8Ω 8W loud-speaker applications. Horn manufactured from Black ABS.

Low-power unit (IAS-2) with choice of sounder module inserts: IAS-2/MT (Mono-Tone), IAS-2/PT (Pulse-Tone) and IAS-2/CT (Chime-Tone). Enclosure manufactured from Black UV-stabilised polycarbonate.

IAS-T Electronic Sounder

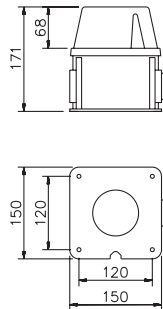

Supply voltage	12Vdc	24Vdc	115Vac	230Vac
Supply voltage limits	± 15%			
Supply current	Dependent upon selected tone			
Sound frequency*	2600Hz			
Sound pressure level @ 1m*	110dB(A)			
Temperature limits	-20C, +55C			
IEC protection class	IP65			

* Preset volume and tone selection will affect both the output frequency and maximum sound pressure level.

Example Order Code: IAS-T/DC/24/Red

IAS-E Electronic Sounder

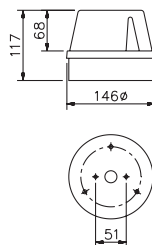

Supply voltage	12Vdc	24Vdc	115Vac	230Vac
Supply voltage limits	± 15%			
Supply current	Dependent upon selected tone			
Sound frequency*	2600Hz			
Sound pressure level @ 1m*	110dB(A)			
Temperature limits	-20C, +55C			
IEC protection class	IP65			

* Preset volume and tone selection will affect both the output frequency and maximum sound pressure level.

Example Code: IAS-E/AC/230/White

For Installation Accessories please refer to page 73

D.G. Controls Limited

Cadley Hill Road, Swadlincote, Derbyshire, DE11 9TB, ENGLAND.

Tel: +44 (0) 1283 550850 Fax: +44 (0) 1283 550776 E-mail: sales@deegee.com www: http://www.deegee.com

Copyright © Reserved

Electronic Sounders

IAS-1

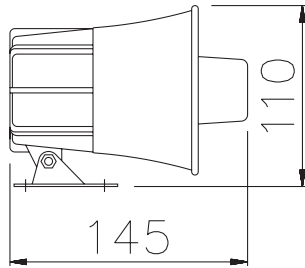

Supply voltage	12Vdc
Supply voltage limits	± 15%
Supply current	700mA
Sound frequency	900-1200Hz up/down sweep
Sound pressure level @ 1m	112dB(A)
Temperature limits	-20C, +55C

Example Order Code: IAS-1/DC/12

IAS-2

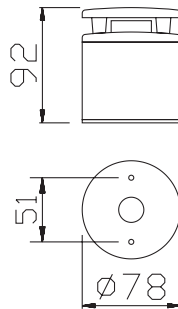

Supply voltage	12Vdc	24Vdc	115Vac	230Vac
Supply voltage limits			± 15%	
Supply current	16mA	32mA	16mA	9mA
Sound frequency			2600Hz	
Sound pressure level @ 1m			92dB(A)	
Temperature limits			-20C, +55C	
IEC protection class			IP54	

Example Order Code: IAS-2/AC/230/PT

IAS-E and IAS-T Sound Selection Table

SW Setting	SPL @1m (dBA)	12V (mA)	24V (mA)	115V (mA)	230V (mA)	1st Tone No.	Tone Description	2nd Tone number
12345								
00000	97	28	24	26	13	1	420 INT @ 625mS/625mS (aus evac)	2
10000	99	30	26	26	13	2	554/440 ALT @ 0.1S/0.4S	1
01000	101	34	30	27	13	3	554/440 ALT @ 1Hz	3
11000	97	37	33	28	14	4	660	4
00100	97	37	33	28	14	5	660 INT 1S on/1S off	5
10100	97	37	33	28	14	6	660 INT @ 1.8S on/1.8S off	6
01100	97	37	33	28	14	7	660 INT @ 6.5S on/13S off	7
11100	102	40	37	28	14	8	800/970 ALT	14
00010	102	45	40	29	14	9	800/970 ALT @ 1Sec/1Sec	14
10010	103	43	39	28	14	10	800-970 SWEEP @ 1Hz	14
01010	102	41	36	28	14	11	800-970 SWEEP @ 7Hz	14
11010	103	42	36	28	14	12	800-970 SWEEP @ 50Hz	14
00110	103	44	40	29	14	13	800-970-800 SWEEP @ 1/1Hz	14
10110	102	45	41	29	14	14	970	14
01110	101	44	41	29	14	15	970 INT @ 1Hz	14
11110	97	27	25	26	13	16	660 INT @ 150mS/150mS	16
00001	101	32	38	27	13	17	970 INT 0.5s on / 0.5s off	17
10001	101	28	27	26	13	18	970 INT @ 0.25s ON/1S OFF	14
01001	103	46	42	29	15	19	1000 (toxic gas alarm)	21
11001	102	46	41	29	14	20	1000 INT @ 1s/1s (gen alarm)	21
00101	101	40	34	28	14	21	1200-500 SWEEP @ 1Hz (papa)	20
10101	102	70	58	32	16	22	2100-1000 SWEEP @ 500mS	23
01101	106	117	97	39	19	23	1600/2100 ALT @ 250mS/250mS	24
11101	105	130	110	40	20	24	1600-2100-1600 SWEEP @ 1s/1s	23
00011	110	148	126	42	21	25	2400/2850 ALT	29
10011	110	165	142	43	21	26	2400-2850 SWEEP @ 1Hz	29
01011	110	152	132	42	21	27	2400-2850 SWEEP @ 7Hz	29
11011	110	156	131	42	21	28	2400-2850 SWEEP @ 50Hz	29
00111	110	157	132	43	22	29	2850	14
10111	110	154	131	42	21	30	2850 INT @ 1Hz	29
01111	110	154	132	42	21	31	2850 INT 0.5s on / 0.5s off	31
11111	110	100	88	36	18	32	2850 INT 150ms on / 100mS off	14

For Installation Accessories please refer to page 73

D.G. Controls Limited

Cadley Hill Road, Swadlincote, Derbyshire, DE11 9TB, ENGLAND.

Tel: +44 (0) 1283 550850 Fax: +44 (0) 1283 550776 E-mail: sales@deegee.com www: http://www.deegee.com

Copyright © Reserved