

# Explosionproof Beacons

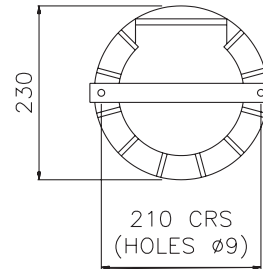

**610EX Housing**

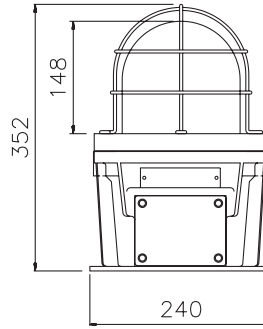
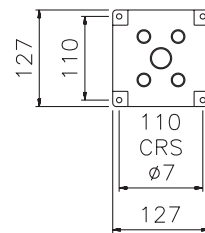
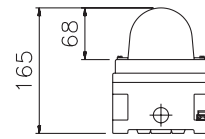

**DEX Housing**

Explosionproof beacon lamps suitable for use in Zone 1 and Zone 2 hazardous areas. Large-format 610EX beacon features white EPC coated LM25 aluminium and wire guard, whilst the DEX housing features hot dipped galvanised cast iron with white EPC coating. A steel wire guard is optional for the DEX housing. Alternative EPC coating colours can be accommodated to suit specific applications.

The full range of beacon interiors is available from simple static filament through to low-current LED and high-energy xenon strobe models.

Two threaded M20 entries are provided as standard; others can be supplied to special order.

## RF/610EX/TH Rotating Mirror Beacon

- Unique 'quiet-drive' system incorporating direct motor/turntable coupling and long life ball-race bearing. Eliminates nuisance of drive belt breakage and reduces drive-train noise.
- All models feature 120mm reflector and tungsten halogen lamp.
- 115Vac and 230Vac models employ a transformer to supply power to the low-voltage 55W halogen lamp.
- 360° All-round visibility.

Supply voltage	12Vdc	24Vdc	115Vac	230Vac
Supply voltage limits			± 15%	
Supply current	4.75A	3A	500mA	250mA
Luminous intensity				
Red	123Cd	157Cd	123Cd	123Cd
Amber	370Cd	472Cd	370Cd	371Cd
Green	222Cd	283Cd	222Cd	222Cd
Blue	74Cd	94Cd	74Cd	74Cd
Clear	494Cd	630Cd	494Cd	494Cd
Lamp rating	55W	70W	55W	55W
Reflector		120mm, ±8°		
Flash/min		180fpm (3Hz)		
Temperature limits		-20C, +55C		
IEC protection class		IP66		
SIRA Certification		Ex II 2G EExdeIICT4 (EN50-014,018&019) Cert. No. 00ATEX1048		

**Example Order Code: RF/610EX/AC/115/TH55/Red**

## XF/610EX/11 Joule Xenon Strobe Beacon

- High energy xenon strobe beacon.
- Repetitive Dual Flash (DH) and Single Flash (SH) models.
- Long-life xenon tube - typically > 20,000,000 flashes.
- 12Vuc, 24Vuc, 115Vac and 230Vac 11 Joule models.
- /SYNC terminals to allow multiple units to be flashed in synchronisation.
- 360° All-round and 270° All-over visibility.

Supply voltage	12Vuc	24Vuc	115Vac	230Vac
Supply voltage limits			± 15%	
Supply current	1.36A	680mA	160mA	80mA
Luminous intensity				
Red		106Cd		
Amber		264Cd		
Green		264Cd		
Blue		88Cd		
Clear		440Cd		
Flash Energy		11J		
Flash Event		DH or SH		
Flash rate adjustment		30,45,60,90 fepm		
Temperature limits		-40C, +55C		
IEC protection class		IP66		
SIRA Certification		Ex II 2G EExdeIICT4 (EN50-014,018&019) Cert. No. 00ATEX1048		

**Example Order Code: XF/610EX/AC/115/DH/11J/Blue**

For Installation Accessories please refer to page 73

**D.G. Controls Limited**

Cadley Hill Road, Swadlincote, Derbyshire, DE11 9TB, ENGLAND.

Tel: +44 (0) 1283 550850 Fax: +44 (0) 1283 550776 E-mail: sales@deegee.com www: http://www.deegee.com

Copyright © Reserved

# Explosionproof Beacons

## XF/DEX/2.5 Joule Xenon Strobe Beacon

- Low-energy, high-intensity xenon strobe beacon.
- Repetitive Single Flash (SH) model.
- Long-life xenon tube - typically > 20,000,000 flashes.
- 12Vdc, 24Vdc, 115Vac and 230Vac 2.5 Joule versions.
- 360° All-round and 270° All-over visibility.
- DC to AC converter (UC-RECT) module available.

Supply voltage	12Vdc	24Vdc	115Vac	230Vac
Supply voltage limits			± 15%	
Supply current	360mA	180mA	120mA	60mA
Luminous intensity	Red		8Cd	
	Amber		24Cd	
	Green		24Cd	
	Blue		8Cd	
	Clear		40Cd	
Flash Energy			2.5J	
Flash Event			SH Only	
Flash rate adjustment			60 fpm (1Hz)	
Temperature limits			-40C, +55C	
IEC protection class			IP66	
BASEEFA Certification	Ex II 2 GD	EExdIIBT85C (EN50-014,018,281-1-1)	to +40C	
Cert. No.03ATEX0653	Ex II 2 GD	EExdIIBT100C (EN50-014,018,281-1-1)	to +50C	

**Example Order Code: XF/DEX/DC/12/SH/2.5J/Red**

## PS/DEX/B15D Pulsed (Flashing) Beacon

- Solid-state operation.
- 12Vdc, 24Vdc, 115Vac and 230Vac versions.
- 24Vac available to order - see 24Vdc models for specification, but order as PS/DEX/AC/24/B15D/\*.
- 50% duty cycle (equal on/off periods).
- 360° All-round and 270° All-over visibility.

Supply voltage	12Vdc	24Vdc	115Vac	230Vac
Supply voltage limits			± 15%	
Supply current	1A	500mA	130mA	65mA
Luminous intensity	Red	3Cd		4Cd
	Amber	9Cd		11Cd
	Green	6Cd		7Cd
	Blue	2Cd		2Cd
	Clear	12Cd		15Cd
Lamp rating		12W		15W
Flash/min			40fpm (0.667Hz)	
Temperature limits			-20C, +55C	
IEC protection class			IP66	
BASEEFA Certification	Ex II 2 GD	EExdIIBT200C (EN50-014,018,281-1-1)	to +40C	
Cert. No.04ATEX0195				

**Example Order Code: PS/DEX/AC/230/B15D/Amber**

## SB/DEX/B15D Static (Non-flashing) Beacon

- Continuously rated indicator lamps.
- Ideal slave unit to conventional or explosionproof **deege** pulsed beacons (not LED).
- Available in the standard voltages of 12V, 24V, 50V, 115V and 230V. AC or DC operation (bulb supplied).
- Also available without fitted bulb (voltage designation 'O').
- 360° All-round and 270° All-over visibility.

Supply voltage	12Vdc	24Vdc	50Vdc	115Vdc	230Vdc
Supply voltage limits			± 15%		
Supply current	1A	500mA	300mA	130mA	65mA
Luminous intensity	Red	3Cd	4Cd		4Cd
	Amber	9Cd	11Cd		11Cd
	Green	6Cd	7Cd		7Cd
	Blue	2Cd	2Cd		2Cd
	Clear	12Cd	15Cd		15Cd
Lamp rating		12W	15W		15W
Temperature limits			-20C, +55C		
IEC protection class			IP66		
BASEEFA Certification	Ex II 2 GD	EExdIIBT200C (EN50-014,018,281-1-1)	to +40C		
Cert. No. 04ATEX0070					

**Example Order Code: SB/DEX/UC/115/B15D/Green**

## RF/DEX/LED Revolving LED Beacon

- Solid-state LED beacon with revolving (simulated rotating) light effect.
- 360° 'all-round' visibility.
- No moving parts.
- High density LED matrix.
- Long-life LEDs (>100,000 hours typical).
- Ultra-low current draw relative to achieved light output.

Supply voltage	12Vdc	24Vdc	115Vac	230Vac
Supply voltage limits			± 15%	
Supply current			25mA	
Number of LEDs	Red		40	
	Amber		40	
	Green		40	
	Blue		24	
	Clear		24	
Luminous intensity			8Cd	
Flash/min			150fpm (2.5Hz)	
Temperature limits			-40C, +55C	
IEC protection class			IP66	
BASEEFA Certification	Ex II 2 GD	EExdIIBT100C (EN50-014,018,281-1-1)	to +40C	
Cert. No. 03ATEX0652	Ex II 2 GD	EExdIIBT200C (EN50-014,018,281-1-1)	to +55C	

**Example Order Code: RF/DEX/AC/230/LED/Red**

For Installation Accessories please refer to page 73

**D.G. Controls Limited**

Cadley Hill Road, Swadlincote, Derbyshire, DE11 9TB, ENGLAND.

Tel: +44 (0) 1283 550850 Fax: +44 (0) 1283 550776 E-mail: sales@deege.com www: http://www.deege.com

Copyright © Reserved

# Explosionproof Beacons

## PS/DEX/LED Pulsed (Flashing) LED Beacon

- Pulsed beacon incorporating high density LED matrix.
- 360° 'all-round' visibility.
- Long-life LEDs (>100,000 hours typical).
- User selectable pulsed/static (flashing/non-flashing) operation by simple jumper link change.
- Very low current draw.

Supply voltage	12Vdc	24Vdc	115Vac	230Vac
Supply voltage limits			± 15%	
Supply current	70mA	35mA	10mA	10mA
Number of LEDs	Red		30	
	Amber		30	
	Green		30	
	Blue		18	
	Clear		18	
Luminous intensity			8Cd	
Flash/min			120fpm (2Hz)	
Temperature limits			-40C, +55C	
IEC protection class			IP66	
BASEEFA Certification	Ex II 2 GD	EExdIIBT100C	(EN50-014,018,281-1-1)	to +40C
Cert. No. 03ATEX0652	Ex II 2 GD	EExdIIBT200C	(EN50-014,018,281-1-1)	to +55C

**Example Order Code: PS/DEX/AC/115/LED/Amber**

## SB/DEX/LED Static (Non-flashing) LED Beacon

- Static (non-flashing) LED beacon.
- 360° 'all-round' visibility.
- High-density LED Matrix.
- Long-life LEDs (>100,000 hours typical).
- Ideal low-current slave to conventional or explosionproof **deege** pulsed beacons (not LED).

Supply voltage	12Vdc	24Vdc	115Vac	230Vac
Supply voltage limits			± 15%	
Supply current	140mA	70mA	20mA	20mA
Number of LEDs	Red		30	
	Amber		30	
	Green		30	
	Blue		18	
	Clear		18	
Luminous Intensity			8Cd	
Temperature limits			-40C, +55C	
IEC protection class			IP66	
BASEEFA Certification	Ex II 2 GD	EExdIIBT100C	(EN50-014,018,281-1-1)	to +40C
Cert. No. 03ATEX0652	Ex II 2 GD	EExdIIBT200C	(EN50-014,018,281-1-1)	to +55C

**Example Order Code: SB/DEX/DC/24/LED/Green**

## SB/DEX/UNI-LED Static Unidirectional LED Beacon

- Uni-directional LED beacon.
- Light exits top of beacon dome.
- Ideal for wall-mounted status signalling.
- Ideal low-current slave to conventional or explosionproof **deege** pulsed beacons (not LED).
- High density LED matrix.
- Long-life LEDs (>100,000 hours typical).

Supply voltage	12Vdc	24Vdc	115Vac	230Vac
Supply voltage limits			± 15%	
Supply current	180mA	90mA	25mA	25mA
Number of LEDs	Red		32	
	Amber		32	
	Green		32	
	Blue*		32	
	Clear*		32	
Luminous intensity			64Cd	
Flash/min			n/a	
Temperature limits			-40C, +55C	
IEC protection class			IP66	
BASEEFA Certification	Ex II 2 GD	EExdIIBT100C	(EN50-014,018,281-1-1)	to +40C
Cert. No. 03ATEX0652	Ex II 2 GD	EExdIIBT200C	(EN50-014,018,281-1-1)	to +55C

\* Blue and Clear currently unavailable in 12Vdc.

**Example Order Code: SB/DEX/AC/230/UNI-LED/Green**

## TP/DEX/LED Telephone Operated - Line Powered

- Solid-state LED telephone operated beacon.
- Telephone-line powered.
- 360° All-round visibility.
- No moving parts.
- High density LED matrix.
- Long-life LEDs (>100,000 hours typical).
- Standard unit supplied without telephone cable.
- Telephone cable can be supplied at extra cost.
- Contact your sales point for details of terminating plug options.

Supply voltage		48 - 75Vdc		
Supply voltage limits			± 15%	
Number of LEDs	Red		30	
	Amber		30	
	Green		30	
	Blue		18	
	Clear		18	
Luminous intensity			8Cd	
Temperature limits			-40C, +55C	
IEC protection class			IP66	
BASEEFA Certification	Ex II 2 GD	EExdIIBT100C	(EN50-014,018,281-1-1)	to +40C
Cert. No.03ATEX-652	Ex II 2 GD	EExdIIBT200C	(EN50-014,018,281-1-1)	to +55C

**Example Order Code: TP/DEX/TR/LED/Amber**

For Installation Accessories please refer to page 73

**D.G. Controls Limited**

Cadley Hill Road, Swadlincote, Derbyshire, DE11 9TB, ENGLAND.

Tel: +44 (0) 1283 550850 Fax: +44 (0) 1283 550776 E-mail: sales@deege.com www: http://www.deege.com

Copyright © Reserved